

M12 M-coding (Power)

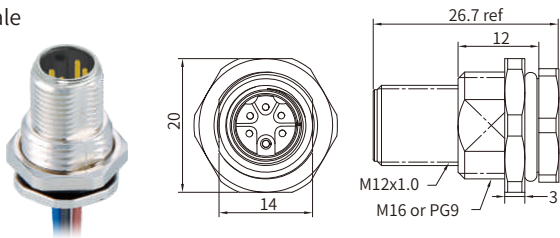

M12 M-coding Straight Connector, Panel Mount, Solder&Crimp, Front fastened

Male



Female

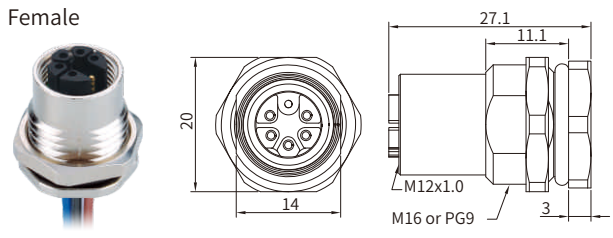

Specifications

Contacts	6 (5+PE)
Pin layout(Male)	
Pin layout(Female)	
Standard	IEC 61076-2-111
Ambient temperature	-20°C~ + 80°C(flexible installation)/-40°C~ + 80°C(fixed installation)
Connector insert	PA + GF
Connector contacts	Brass with nickel plated
Connector overmold	TPU
Coupling nut/screw:	Brass with nickel plated
Seal / O-ring	FKM
Insulation resistance	≥100MΩ
Contact resistance	≤5mΩ
Shielding	Unavailable
IP rating	IP67, IP68 in locked condition
Rated current	8 A
Rated voltage	630V AC/DC
Wire gauge	1.5mm ² (AWG16)
Panel cut-out	Refer to page 384

Part Number

Pins	Cable length	Connection Type	公头		母头	
			M16x1.5	PG9	M16x1.5	PG9
6	0.1m	Solder	MB12MSMFF06ST-215001	MB12MSMFF06ST-315001	MB12FSMFF06ST-215001	MB12FSMFF06ST-315001
			MB12MSMFF06ST-215003	MB12MSMFF06ST-315003	MB12FSMFF06ST-215003	MB12FSMFF06ST-315003
	0.3m	Crimp	MB12MCMFF06ST-215001	MB12MCMFF06ST-315001	MB12FCMFF06ST-215001	MB12FCMFF06ST-315001
			MB12MCMFF06ST-215003	MB12MCMFF06ST-315003	MB12FCMFF06ST-215003	MB12FCMFF06ST-315003

Default wire colors

Pin No.	
Pin 1	BN
Pin 2	WH
Pin 3	BU
Pin 4	BK
Pin 5	GY
Pin 6	YE/GN